

LARKIN

PUMPING TEES

3000 PSI WORKING PRESSURE

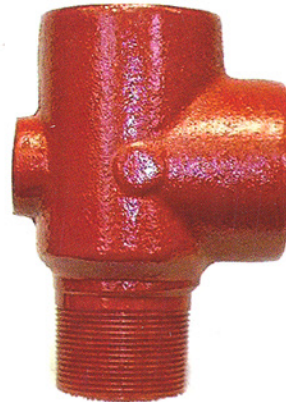
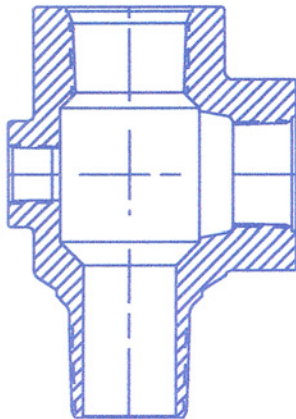
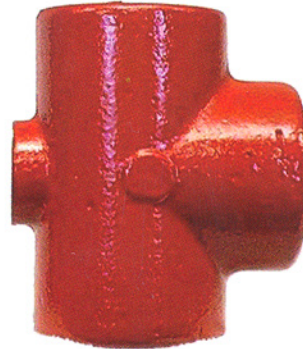
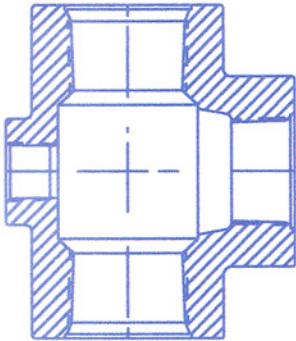

CONTROL PUMPING TEE BODY

PART #	TOP CONNECTION	BOTTOM CONNECTION	OUTLET	PORT	WOG	MATERIAL
Ø54-212-124Ø	2 3/8" EUE 8 RD TBØ.	2 3/8" EUE 8 RD TBØ.	2" L.P.	1" NPT	150Ø # W.P.	DUCTILE
Ø54-213-124Ø	2 3/8" EUE 8 RD TBØ.	2 7/8" EUE 8 RD TBØ.	2" L.P.	1" NPT	150Ø # W.P.	DUCTILE
Ø54-213-624Ø	2 3/8" EUE 8 RD TBØ.	2 1/2" 8 V L.P.	2" L.P.	1" NPT	150Ø # W.P.	DUCTILE
Ø54-213-636Ø	2 3/8" EUE 8 RD TBØ.	2 1/2" 8 V L.P.	2 1/2" L.P.	1" NPT	150Ø # W.P.	DUCTILE
Ø54-214-646Ø	2 3/8" EUE 8 RD TBØ.	3" 8 V L.P.	3" L.P.	1" NPT	150Ø # W.P.	DUCTILE
Ø54-243-146Ø	2" 11 1/2 V L.P.	2 7/8" EUE 8 RD TBØ.	3" L.P.	1" NPT	150Ø # W.P.	DUCTILE
Ø54-313-124Ø	2 7/8" EUE 8 RD TBØ.	2 7/8" EUE 8 RD TBØ.	2" L.P.	1" NPT	150Ø # W.P.	DUCTILE
Ø54-313-136Ø	2 7/8" EUE 8 RD TBØ.	2 7/8" EUE 8 RD TBØ.	2 1/2" L.P.	1" NPT	150Ø # W.P.	DUCTILE
Ø54-313-146Ø	2 7/8" EUE 8 RD TBØ.	2 7/8" EUE 8 RD TBØ.	3" L.P.	1" NPT	150Ø # W.P.	DUCTILE
Ø54-363-624Ø	2 1/2" 8 V L.P.	2 1/2" 8 V L.P.	2" L.P.	1" NPT	150Ø # W.P.	DUCTILE
Ø54-464-624Ø	3" 8 V L.P.	3" 8 V L.P.	2" L.P.	1" NPT	150Ø # W.P.	DUCTILE
Ø54-515-136Ø	3 1/2" EUE 8 RD TBØ.	3 1/2" EUE 8 RD TBØ.	2 1/2" L.P.	1" NPT	150Ø # W.P.	DUCTILE
Ø55-212-124Ø	2 3/8" EUE 8 RD TBØ.	2 3/8" EUE 8 RD MALE	2" L.P.	1" NPT	150Ø # W.P.	DUCTILE
Ø55-212-424Ø	2" 11 1/2 V L.P.	2 3/8" EUE 8 RD MALE	2" L.P.	1" NPT	150Ø # W.P.	DUCTILE
Ø55-313-124Ø	2 7/8" EUE 8 RD TBØ.	2 7/8" EUE 8 RD MALE	2" L.P.	1" NPT	150Ø # W.P.	DUCTILE
Ø55-313-146Ø	2 7/8" EUE 8 RD TBØ.	2 7/8" EUE 8 RD MALE	3" L.P.	1" NPT	150Ø # W.P.	DUCTILE
Ø55-464-646Ø	3" 8 V L.P.	3" 8 V MALE	3" L.P.	1" NPT	150Ø # W.P.	DUCTILE
Ø55-514-646Ø	3" 8 V L.P.	3 1/2" EUE 8 RD MALE	3" L.P.	1" NPT	150Ø # W.P.	DUCTILE